

# INSTRUCTION MANUAL

. . . with Catalog of Replacement Parts

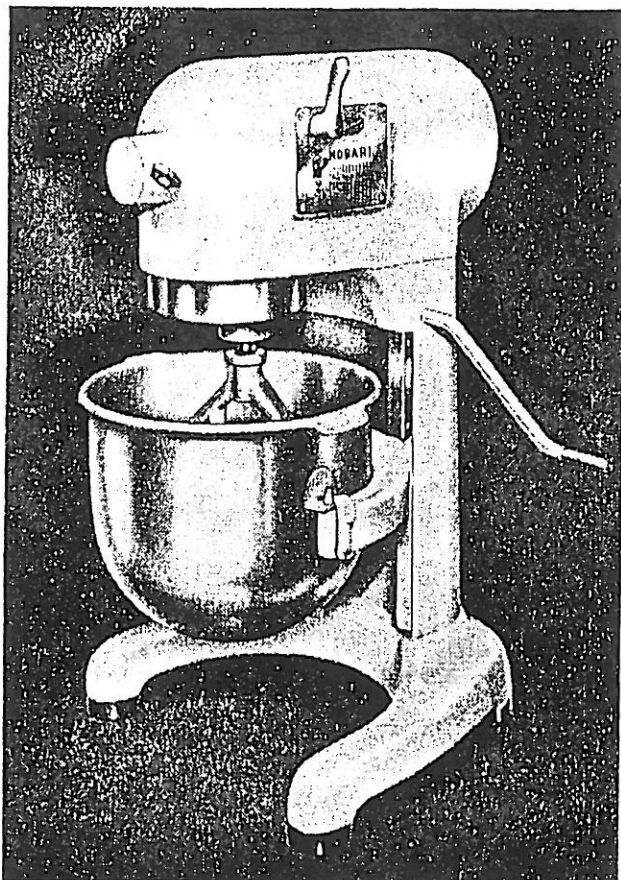

## HOBART

MODELS C-100 AND C-100T MIXERS

M/L #6307 — C-100

M/L #6340 — C-100T

**HOBART.**

*The World's Oldest and Largest Manufacturer of Computing Scales  
and Food Store, Kitchen, Bakery and Dishwashing Machines*

**THE HOBART MANUFACTURING COMPANY** TROY, OHIO

FORM 3779-E (Revised Aug. 1966) (Supersedes Form 3779-D, Jan. 1964)

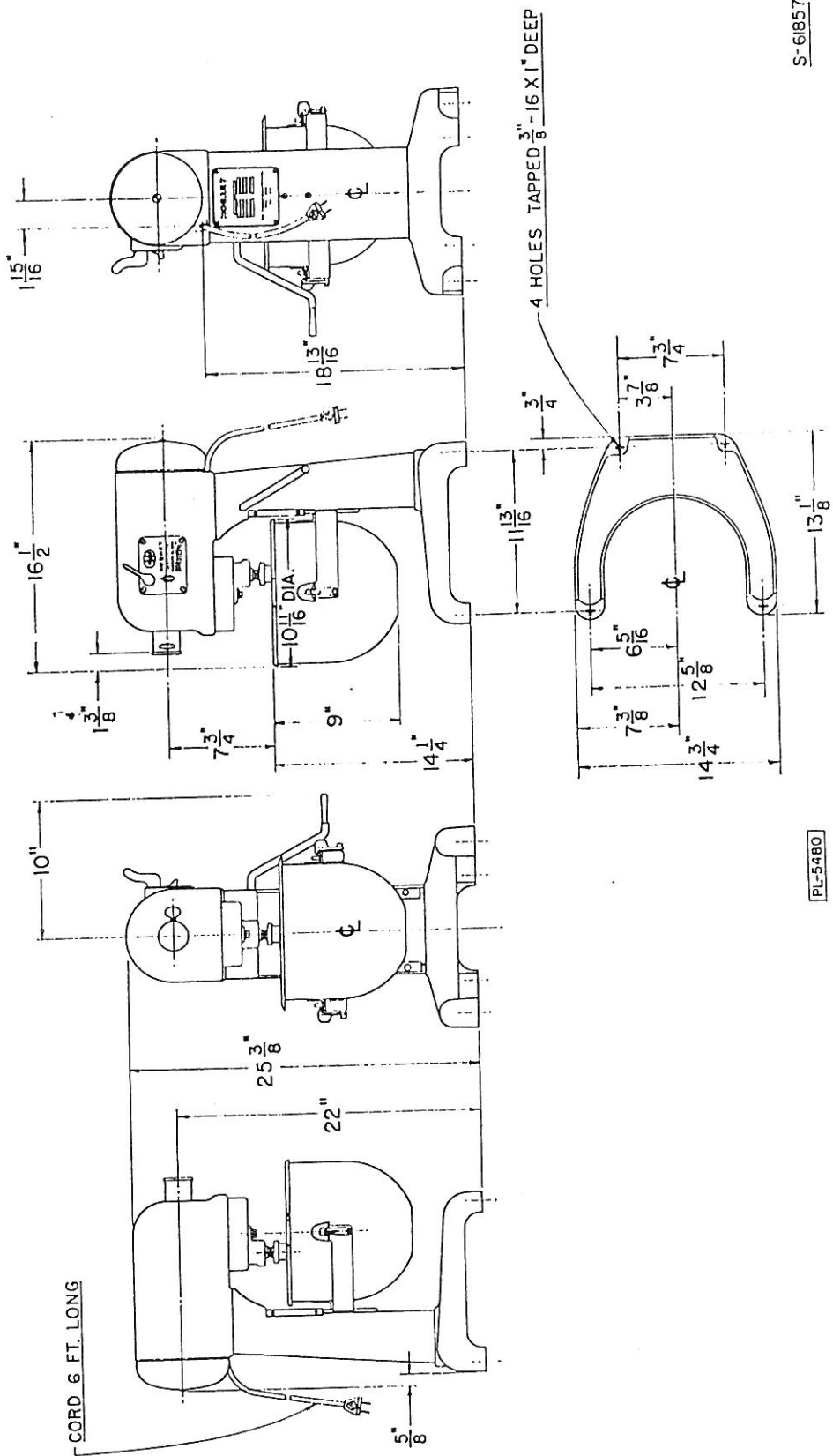

INSTALLATION DIAGRAM

## Instructions for Operation and Care of Models C-100 & C-100T Hobart Mixers

**CONNECTIONS:** All machines are furnished with cord and plug (1). Be sure line current available is the same as specified on the machine data plate (2) before plugging into socket.

If cord and plug is not used with this machine, electrical connections should be made by qualified workmen who will observe all applicable Safety Codes and the National Electrical Code.

### C-100

Set the shifter handle (6) at the desired speed and turn on the switch to start the motor.

### C-100T

To start the motor for non-timed operation, set the shifter handle (6) at the desired speed, then set the timer on hold and turn on the switch. For timed operation set the timer for the desired time and then turn on the switch.

**LUBRICATION:** The motor has grease packed ball bearings, so will require little attention. The transmission gearing is packed with a special grease that will last for several years. When grease is needed for replacement, it should be ordered from us. Lubricate the bowl slideways (3) occasionally, by applying a very small amount of oil with the tip of your finger. Only mineral oils are suitable for this type of lubrication. The polished drip cup (4) is a safe-guard to prevent any lubricant that might work out of the planetary gearing from dropping into the bowl. Take off the drip cup (by removing the two screws (5)) once a month and wipe it clean.

**SPEED CONTROL:** To change speeds, first turn off the motor, then shift the speed handle (6) to the desired speed. In the illustration the handle is set for number 1 or low speed. The number 1 or low speed is for heavy mixtures such as dough and heavy batters. Speed number 2 is for mashing potatoes and for cake batters. Number 3 or high speed is for fast light work such as whipping cream, whipping potatoes after mashing, beating eggs, and mixing thin batters. In many mixing operations, it is proper to start on number 1 and then change to a higher speed as the work progresses.

**BOWL LIFT:** To raise the bowl, pull the lever (7) down until it catches in the detent which holds it in position. It is necessary to lower the bowl in order to change beaters, and also makes the bowl more accessible for filling. To mash potatoes, start with the bowl down, and raise it slowly into working position.

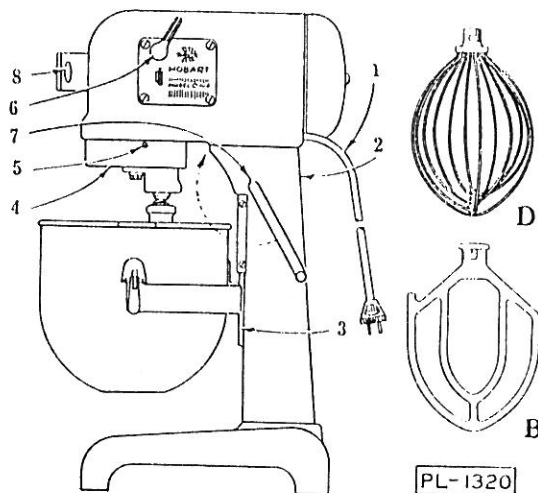

**AGITATORS:** The two shown in the illustration are:

Style 'B', Flat Beater, used for thin batters, cakes, and for mashing potatoes.

Style "D", Wire Whip, used for whipping cream, and beating eggs.

Two other styles frequently used are:

Style "E", Dough Arm, for bread or roll dough.

Style "P", Pastry Knife, for cutting shortening into flour for pastry.

**ATTACHMENTS:** Any of the following No. 10 size attachments will fit this mixer; vegetable slicer and shredder, meat chopper, fruit juice extractor, salad oil tank, and colander. Stop the motor before putting an attachment into the hub, then insert with a slight twist toward the left so that the stop stud of the attachment is tight against the side of the hole in the hub that receives it. When properly in place, tighten the thumb screw (8).

The attachment drive has three speeds, governed by the speed handle of the mixer. It is recommended that the chopper attachment should be run at number 3 speed. Other attachments should be run at a speed best suited for their operation. Use the motor switch to start and stop attachments, and always stop the motor before changing the speed of an attachment.

**CARE OF MOTOR:** Most motors will require little or no attention. If you have a direct current motor, have a Hobart service technician inspect it once a year, to clean the commutator and replace the brushes if needed.



BOWL SUPPORT, BOWL AND LIFT UNIT

ILLUS. PL-2523	PART NO.	NAME OF PART	AMT.
1	SC-8-62	Mach. Screw - #12-24 x 1/2" Rd. Hd. -----	1
2	M-66796	Spacer - Bowl Clamp (3 Qt.) -----	1
3	V-3607-2	Clamp - L.H. Bowl (3 Qt.) -----	1
4	M-62661	Adapter and Bowl Pin Sub-Assy. (3 Qt.) (Incls. item #7)-----	1
5	V-3608	Latch - Bowl (3 Qt.) -----	1
6	SC-8-62	Mach. Screw - #12-24 x 1/2" Rd. Hd. -----	1
7	M-3601	Pin - Bowl Support Retaining -----	1
8	V-3607-1	Clamp - R.H. Bowl (3 Qt.) -----	2
9	M-66796	Spacer - Bowl Clamp (3 Qt.) -----	1
10	SC-8-62	Mach. Screw - #12-24 x 1/2" Rd. Hd. -----	1
11	M-3601	Pin - Bowl Support Retaining -----	1
12	M-62625-1	Bowl Support Sub-Assy. (Incls. items #11 & 13) -----	2
13	M-61670	Bushing - Bowl Clamp -----	1
14	M-61678	Clamp - Bowl -----	2
15	SC-11-68	Mach. Screw - #12-24 x 1" Fil. Hd. -----	2
16	SC-13-46	Mach. Screw - #10-24 x 1/2" Flat Hd. -----	2
17	M-61648	Glb - Bowl Support -----	8
18	M-62905	Shim - Bowl Support -----	2
19	M-61651	Stud - Bowl Lift ----- As Req'd.	
20	PC-3-32	Cotter Pin - 3/32" x 1/2" -----	1
21	P-61640	Handle - Bowl Lift -----	1
22	WS-6-48	Washer -----	1
23	RP-2-22	Rollpin - 5/32" Dia. x 3/4" Lg. -----	2
24	RP-2-40	Rollpin - 3/32" Dia. x 3/4" Lg. -----	1
25	M-61650	Arm - Lift -----	1
26	P-61641	Rod - Lift -----	1
27	PC-3-32	Cotter Pin - 3/32" x 1/2" -----	1
28	V-20598	Spring -----	1
29	S-61964-1	Bowl Assy. (10 Qt.) -----	1
30	R-62258-1	Bowl Assy. (3 Qt.) -----	1
31	R-61859-1	Cover - Splash (10 Qt.) -----	1
32	P-8764	Cover - Splash (3 Qt.) -----	1
	M-24661	Adapter Unit Assy. (3 Qt.) (Incls. items #1 thru 10) -----	1

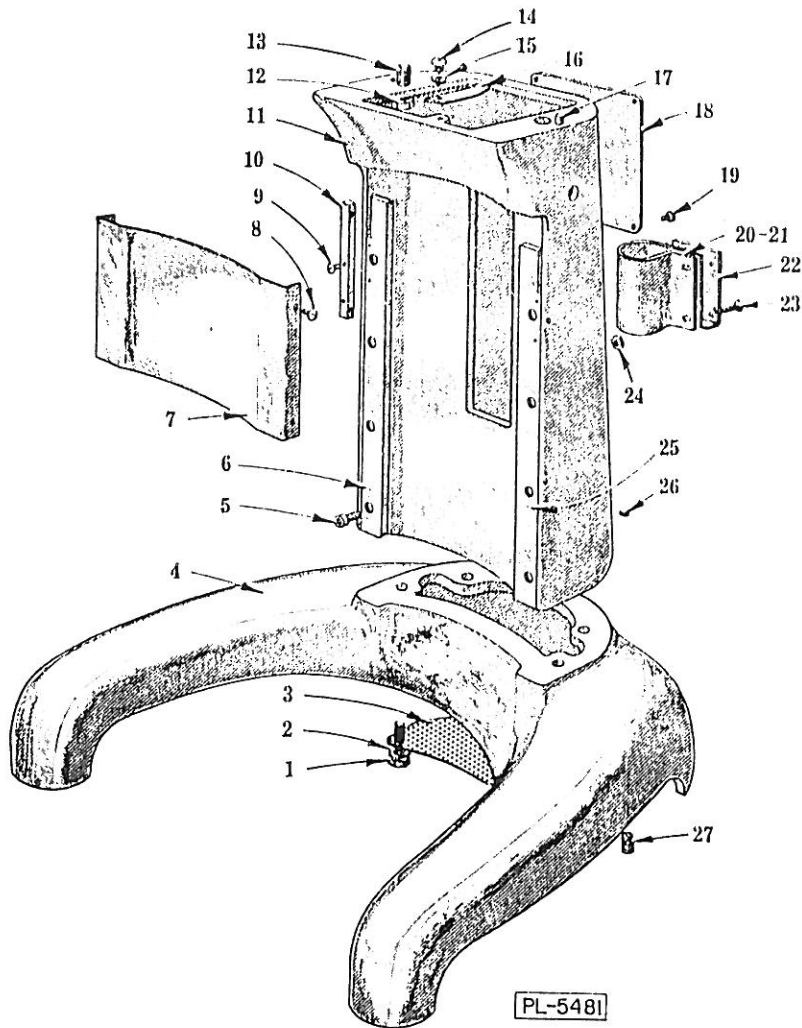

PL-5481

BASE AND PEDESTAL UNIT

ILLUS. NO.	PART NO.	NAME OF PART	AMT.
1	SC-36-27	Fin. Bolt - 5/16"-18 x 1" Hex Hd.	4
2	WL-3-44	Lock Washer - 5/16" x .125" x .078"	4
3	P-78507	Screen - Air	1
4	T-61680-1	Base	1
5	SC-40-51	Cap Screw - #8-32 x 1/2" Soc. Fil. Hd.	8
6	P-61638-1	Slideway - Left Hand	1
7	P-61635	Apron	1
8	SC-9-93	Mach. Screw - #6-32 x 1/4" Rd. Hd.	4
9	SC-7-23	Mach. Screw - #6-32 x 3/8" Rd. Hd.	4
10	M-61669	Block - Apron	2
11	T-61683-1	Pedestal	1
12	WL-4-2	Lock Washer - 3/8" x .136" x .070"	2
13	SC-36-57	Fin. Bolt - 3/8"-16 x 1-1/4" Hex Hd.	2
14	SC-7-41	Mach. Screw - #8-32 x 3/8" Rd. Hd.	1
15	WL-3-15	Lock Washer - #8 x .047" x .031"	1
16	M-61649	Spring - Bowl Lift Detent	1
17	P-11800-88	Dowel	2
18	P-85098	Plate - Mach. Data & Back Cover (Give serial No. & elec. spec.)	1
19	SC-19-26	Mach. Screw - #6-32 x 1/4" Bind. Hd.	4
20	M-20334	Bracket - Capacitor (60 Cy.)	1
21	M-21227	Bracket - Capacitor (50 Cy.)	1
22	M-64228	Support - Capacitor Bracket	1
23	SC-15-36	Mach. Screw - #10-24 x 5/8" Oval Hd.	2
24	NS-9-21	Mach. Nut - #10-24 Hex	2
25	P-61639-1	Slideway - Right Hand	1
26	SC-47-71	Set Screw - #6-32 x 1/8" Soc. Hdls. Flat Pt.	2
27	SC-57-15	Set Screw - 3/8"-16 x 5/8" Hdls. Cup Pt.	4

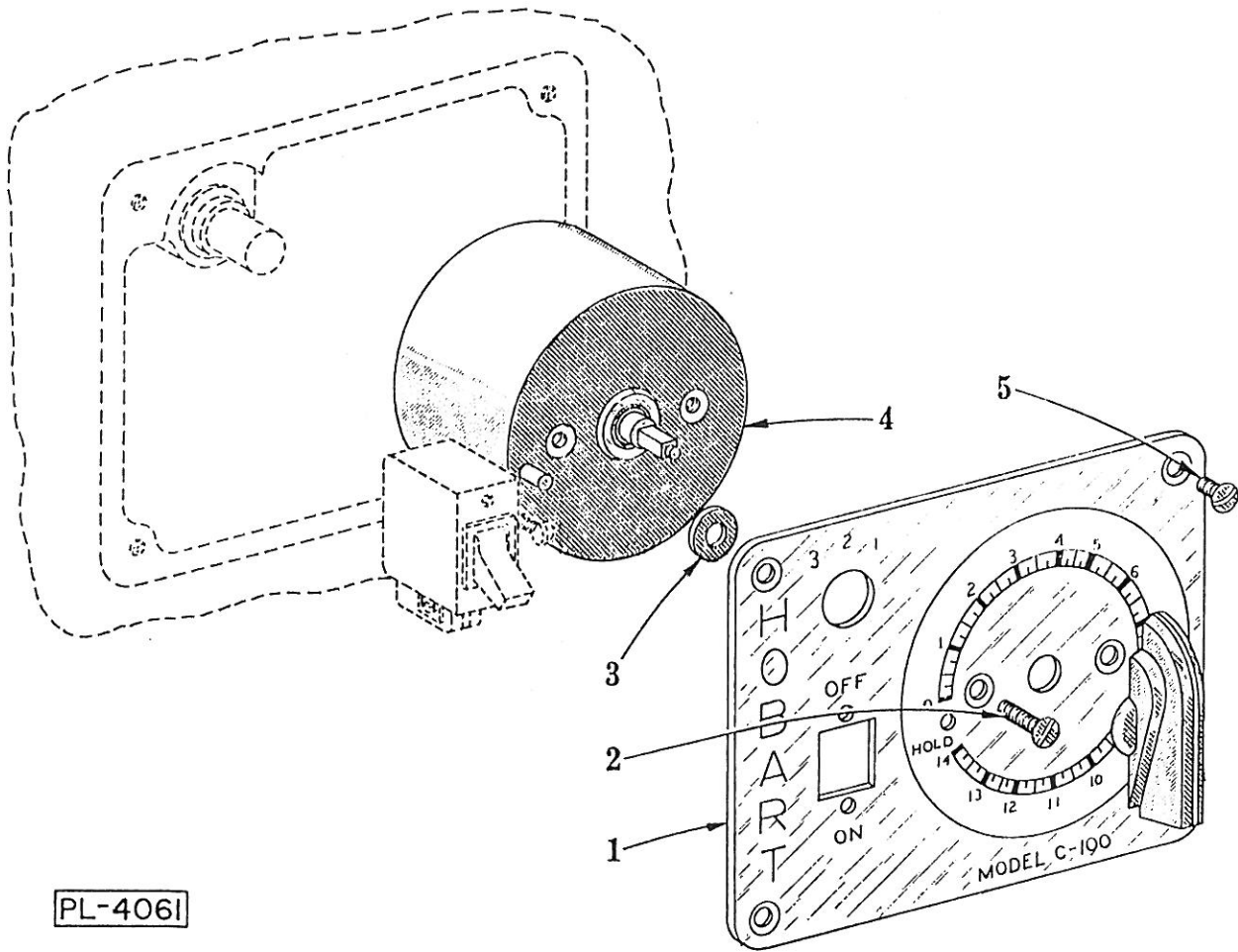

PL-4061

TIMER UNIT

ILLUS. NO.	PART NO.	NAME OF PART	AMT.
1	P-61637	Plate - Switch	1
2	SC-14-41	Mach. Screw - #5-40 x 3/8" Flat Hd.	2
3	WS-2-18	Washer (Between Timer & Plate)	2
4	P-86087	Timer	1
5	SC-15-8	Mach. Screw - #6-32 x 1/4" Oval Hd.	4

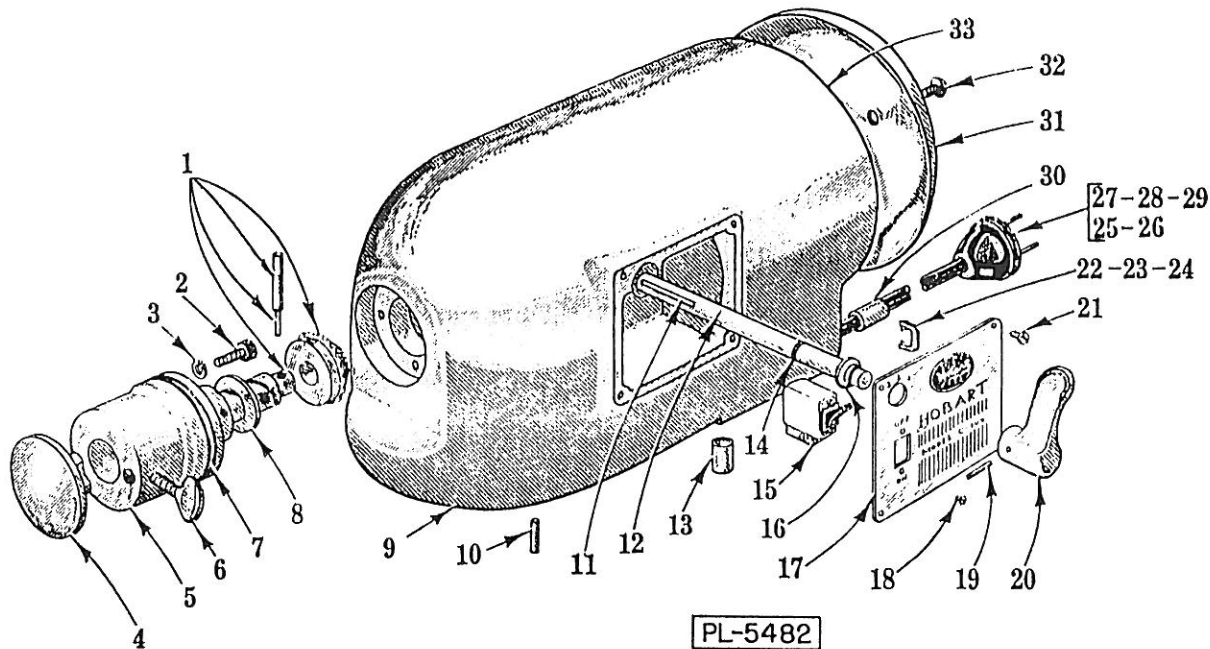

TRANSMISSION CASE UNIT

ILLUS. NO.	PART NO.	NAME OF PART	AMT.
1	M-65464	Square Drive Shaft & Zerol Bevel Gear Assy. (23T)	1
2	SC-40-53	Cap Screw - #10-24 x 7/8" Soc. Fil. Hd.	3
3	WL-3-23	Lock Washer - #10 x .070" x .056"	3
4	M-61838	Cover - Attachment Hub	1
5	P-61631	Hub - Attachment	1
6	M-5500	Thumb Screw	1
7	R-67500-20	"O" Ring	1
8	M-61667	Washer - Thrust	1
9	M-62628	Gear Case, Dowel & Bushing Sub-Assy. (Incls. items #10 & 13)	1
10	P-11800-84	Dowel	1
11	R-12430-3	Key	1
12	M-61653	Rod - Shifter	1
13	M-61672	Bushing (Fiber)	1
14	R-67500-2	"O" Ring	1
15	M-61870	Switch	1
16	RR-4-4	Retaining Ring	1
17	P-61853	Plate - Switch	1
18	SC-9-87	Mach. Screw - #3-48 x 1/4" Rd. Hd.	2
19	PG-3-32	Groov-Pin - Type #1, 1/8" x 3/4"	1
20	M-61677	Handle - Shifter	1
21	SC-15-8	Mach Screw - #6-32 x 1/4" Oval Hd.	4
22	FE-6-15	Strain Relief (For item #25)	1
23	FE-6-16	Strain Relief (For item #26)	1
24	FE-6-32	Strain Relief (For items #27 & 28)	1
25	S-63335-12	Cord & Plug (2 Cond., Under 125 V.)	1
26	S-63335-17	Cord & Plug (2 Cond., 200-250 V.)	1
27	S-63335-30	Cord & Plug (3 Cond., Under 150 V.) (Ground)	1
28	S-63335-43	Cord & Plug (3 Cond., 200-250 V.) (Ground)	1
29	R-64898-4	Cord - Export	1
30	M-61672	Bushing (Fiber)	1
31	P-61634	Cover - Bearing Bracket	1
32	SC-10-13	Mach. Screw - #10-24 x 3/8" Truss Hd.	1
33	-----	Motor (see separate Motor Parts Sheet)	1



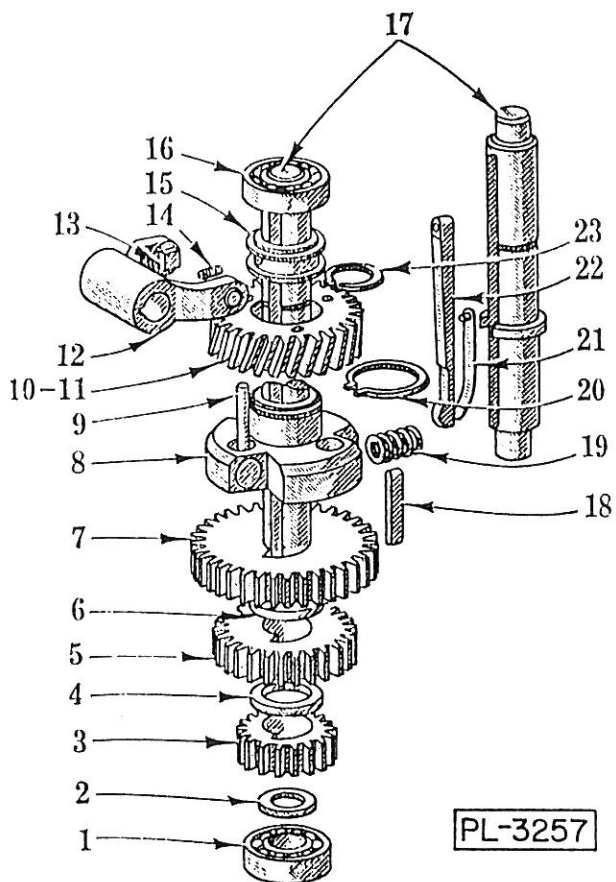

TRANSMISSION GEAR UNIT

ILLUS. NO.	PART NO.	NAME OF PART	AMT.
1	BB-5-6	Bull Bearing - N.D. #3201	1
2	M-61657	Spacer	1
3	M-61658	Gear (18T)	1
4	V-3568	Collar - Spacing	1
5	M-61659	Gear (27T)	1
6	V-3568	Collar - Spacing	1
7	M-61660	Gear (37T)	1
8	P-61643	Flange - Drive	1
9	M-61652	Pin - Drive	3
10	M-62626-1	Worm Gear & Pin Sub-Assy. (28T) (60 Cy.) (Incls. item #9)	1
11	M-62626-2	Worm Gear & Pin Sub-Assy. (31T) (25-50 Cy.) (Incls. item #9)	1
12	M-61654	Yoke - Shifter	1
13	M-61655	Shoe - Shifter	2
14	M-61947	Screw - Diving Key	1
15	M-61656	Sleeve - Clutch Shifter	1
16	BB-5-6	Bull Bearing - N.D. #3201	1
17	P-61642	Shaft - Main Drive	1
18	R-12430-63	Key	1
19	M-18046	Spring	3
20	RR-4-11	Retaining Ring	1
21	V-18641	Stud and Spring Assy.	1
22	P-61645	Key - Diving	1
23	RR-4-20	Retaining Ring	1
	M-62489	Deflector - Grease	1

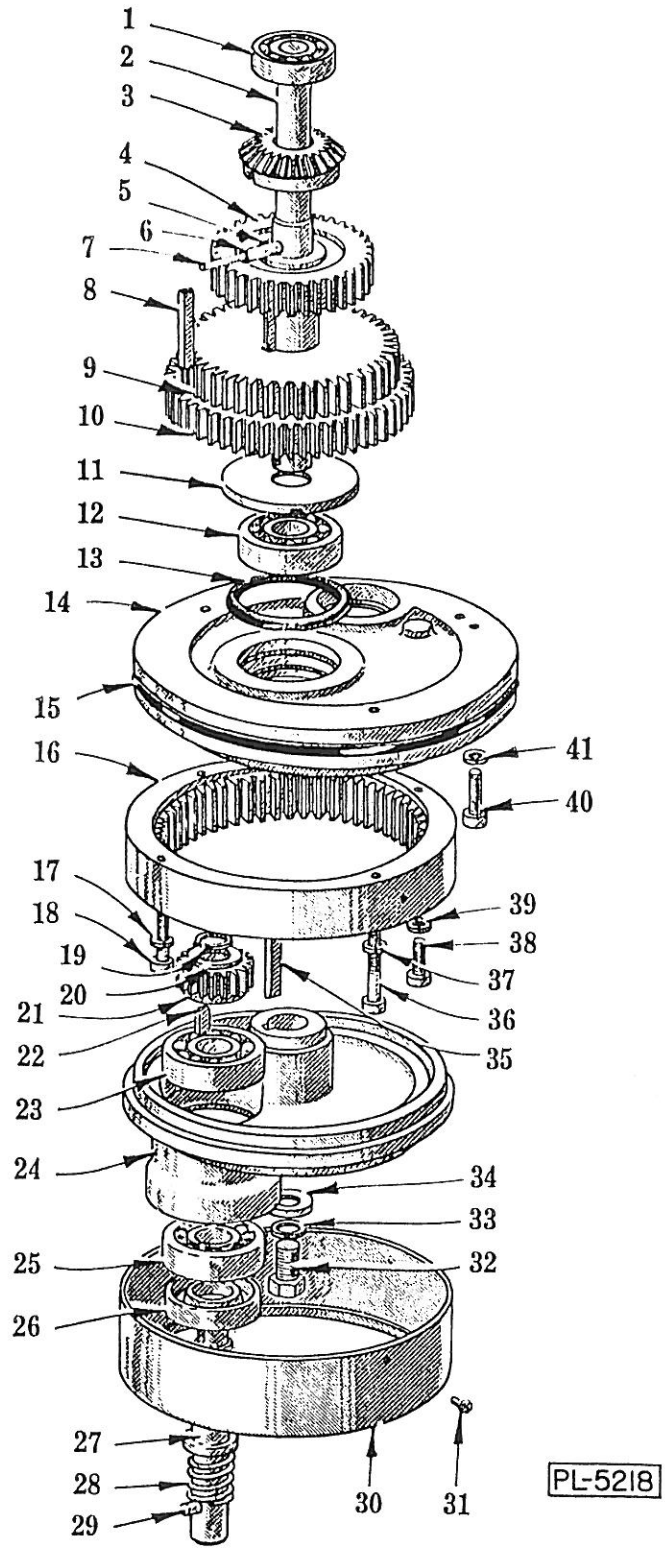

PL-5218

PLANETARY UNIT

## PLANETARY UNIT

ILLUS. PL-5218	PART NO.	NAME OF PART	AMT.
1	BB-5-6	Ball Bearing - N.D. #3201	1
2	P-61676	Shaft - Planetary	1
3	M-61674	Gear - Miter (23T)	1
4	M-61661	Gear (36T)	1
5	M-61673	Shim (Give Thickness)	As Req'd.
6	RP-2-21	Rollpin - 5/32" Dia. x 1-1/2" Lg.	1
7	RP-2-39	Rollpin - 3/32" Dia. x 1-1/2" Lg.	1
8	R-12430-67	Key	1
9	M-61663	Gear (46T)	1
10	M-61662	Gear (55T)	1
11	M-61675	Spacer	1
12	BB-18-36	Ball Bearing - N.D. #99503	1
13	R-67500-14	"O" Ring	1
14	R-61629	Plate - Bottom Cover	1
15	R-67500-23	"O" Ring	1
16	P-61646	Gear - Internal (64T)	1
17	WL-3-22	Lock Washer - #10 x .055" x .040"	1
18	SC-40-54	Cap Screw - #10-24 x 1" Soc. Fil. Hd.	1
19	RR-4-17	Retaining Ring	1
20	M-61664	Retainer - Agitator Pinion	1
21	M-61665	Pinion - Beater (19T)	1
22	R-12430-46	Key	1
23	BB-5-23	Ball Bearing - N.D. #Z99503	1
24	R-72731	Planetary	1
25	BB-5-23	Ball Bearing - N.D. #Z99503	1
26	M-72746	Oil Seal	1
27	M-61996	Agitator Shaft & Pln Assy. (Incls. Items #28 & 29)	1
28	V-4538	Spring - Agitator Shaft	1
29	P-11800-92	Dowel	1
30	P-61633	Drip Cup	1
31	SC-32-9	Mach. Screw - #6-32 x 3/16" Bind. Hd.	2
32	SC-62-59	Fin. Bolt - 5/16"-18 x 5/8" Hex Hd.	1
33	WL-6-23	Lock Washer - 5/16" x .125" x .078"	1
34	M-61666	Washer - Planetary Retaining	1
35	R-12430-9	Key	1
36	SC-40-55	Cap Screw - #10-24 x 1-1/2" Soc. Fil. Hd.	2
37	WL-3-22	Lock Washer - #10 x .055" x .040"	2
38	SC-40-52	Cap Screw - #10-24 x 3/4" Soc. Fil. Hd.	1
39	WL-3-22	Lock Washer - #10 x .055" x .040"	1
40	SC-40-52	Cap Screw - #10-24 x 3/4" Soc. Fil. Hd.	1
41	WL-3-22	Lock Washer - #10 x .055" x .040"	1

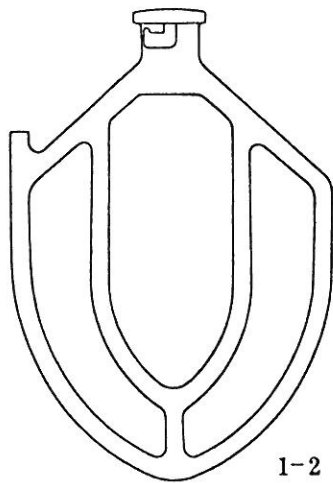

1-2

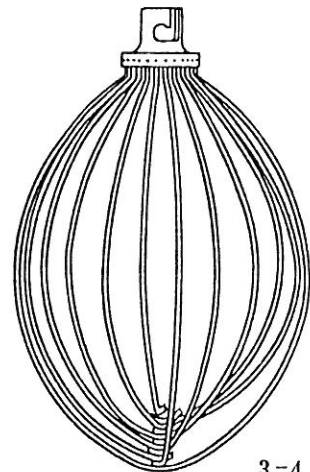

3-4

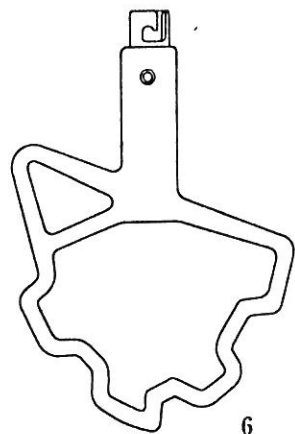

6

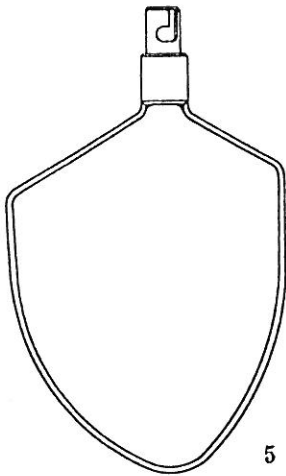

5

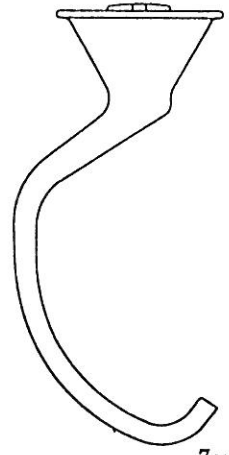

7-8

PL-1242

AGITATORS

ILLUS. NO.	PART NO.	NAME OF PART	AMT.
1	R-61628	B - Flat Beater (10 Qt.)	1
2	R-62345-1	B - Flat Beater (3 Qt.)	1
3	R-77760-1	D - Wire Whip (10 Qt.)	1
4	P-77762	D - Wire Whip (3 Qt.)	1
5	P-11954	P - Pastry Knife (10 Qt.)	1
6	P-6140	S - Sweet Dough Beater (10 Qt.)	1
7	R-61858	E - Dough Arm (10 Qt.)	1
8	P-6362	E - Dough Arm (3 Qt.)	1