







FRENCH FRY CUTTER

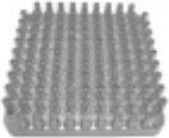
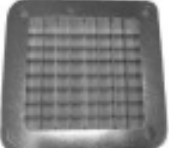

FEATURES

- Heavy duty cast body
- Rust proof stainless steel tray and blades
- Cut up to 50 lbs. of potatoes per hour
- Wall or table mounted
- Product Dim : 13" x 7.75" x 20"
- Shipping Dim: 19.5" x 8.5" x 8.5"
- Net / Gross Wt: 12 / 14 lbs

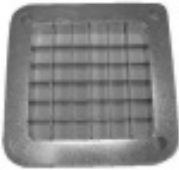
ITEM ID	CUT
UFC-2500	1/4" Cut
UFC-3750	3/8" Cut
UFC-5000	1/2" Cut

CUTTING FRAMES	PUSHER BLOCKS
 UFC-F2500	 UFC-P2500
 UFC-F3750	 UFC-P3750
 UFC-F5000	 UFC-P5000

ITEM ID	DESCRIPTION	QTY / CS	LBS / CS
UFC-F2500	Cutting Frame - 1/4"	3	2
UFC-F3750	Cutting Frame - 3/8"	3	2
UFC-F5000	Cutting Frame - 1/2"	3	2
UFC-P2500	Pusher Block - 1/4"	3	1
UFC-P3750	Pusher Block - 3/8"	3	1
UFC-P5000	Pusher Block - 1/2"	3	1

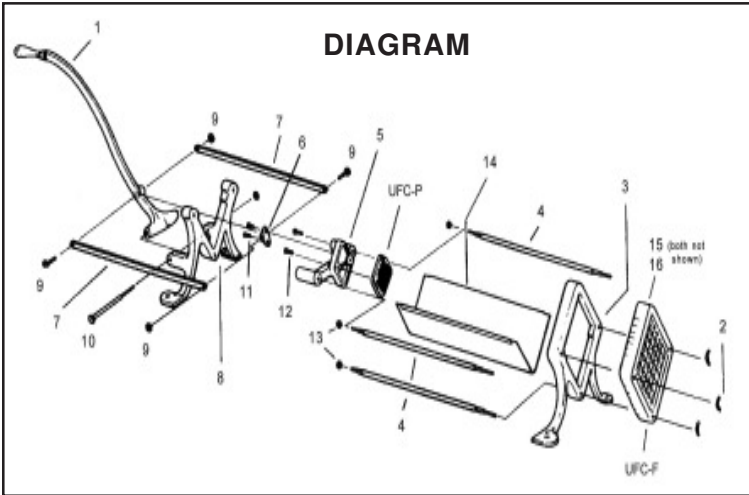

PARTS LIST

#	ITEM NO.	DESCRIPTION
1	UFC - 01	Handle
2	UFC - 02	Wing Nuts
3	UFC - 03	Front Legs
4	UFC - 04	Slide Rod
5	UFC - 05611	Pusher Bracket Plate incl. Bracket & Connctr Screw (set)
7	UFC - 07	Connecting Link
8	UFC - 08	Rear Leg
9	UFC - 09	Link Connector Screw & Nut
10	UFC - 10	Bolt Nut and Screw
12	UFC - 12	Pusher Block Screw
13	UFC - 13	Slide Rod Nut
14	UFC - 14	Tray
15	UFC - 15	Blade Locking Screw
16	UFC - 16	Blade Locking Bar

Uniworld Foodservice Equipment, Inc.
 6361 Chalet Drive, Commerce, CA 90040
 Toll Free Phone: (888) 777-0671; Fax: (888) 888-3185
 Website: www.uniworldfoodequip.com

